



USE AND CARE MANUAL
E6010.00 SHAKER POWER UNIT

Two Speed
180/280 osc/min

Volts: 115V
Hz: 60Hz
Amps: 3.4A
Fuse: 5A Time Delay



USE AND CARE FOR CATALOG NUMBER:

- E6010.00 Two Speed Power Unit, 180 & 280 osc/min.

INITIAL PREPARATION:

This shaker power unit is furnished without carriers and prior to installation of any carrier the unit should be run. With the switch in the off position (center – off for E6010.00), plug the line cord into a 115 Volt, 60 Hz source. Turn shaker on by moving switch to the “Slow” position. Proceed to carrier installation.

OPERATION:

Because an oscillating mechanism such as a shaker tends to “walk”, caution must be exercised when installing it for use.

Shaking apparatus must be placed on a rigid bench or table, or directly on the floor. Suction type rubber feet are provided; therefore, the surface must be free of cracks or voids and must be clean, especially free of dust, oil or wax.

If the shaker starts “walking”, it may need to be cemented to the mounting surface. At no time should the load exceed 40lbs.

If it is necessary to cement the shaker to a mounting surface, we suggest the use of a rubber bonding cement. When applying rubber bonding cement, follow manufacturer’s directions.

To move the shaker after it has been cemented to a surface, it is necessary to free the feet with a sharp knife or razor blade to keep from damaging the feet.

For optimum operation of this shaking apparatus and for long trouble-free life, it is recommended that a minimum load be placed in the shaker when used.

OILING AND ALL MAINTENANCE CAN BE PERFORMED BY REMOVING EITHER THE FRONT OR REAR HOUSING PANEL.

BELT INSPECTION:

Inspect belt at each oiling period and replace if actually broken or if the cords are exposed and frayed. Small outer fabric breaks are not harmful.

BELT REPLACEMENT AND ADJUSTMENT:

To replace belt, loosen motor screws and remove belt, then install new belt. Tighten the motor screws, but do not tighten belt to the point where the bearings will be overloaded. Once the belt is tight, the operator should be able to press lightly on the middle of the belt and cause it to bow in an amount equal to the width of the belt.

LUBRICATION:

See exploded view of shaker power unit for points of lubrication. Use a good grade of SAE #30 oil.

Lubrication when shaker is used in continuous duty applications of 100 hours or more:

- A. Oil crank bearing through hole in center of bearing bracket every 3 months.
- B. Oil the 8 bearings located at the top and bottom of each of the 4 rocker arms every 3 months. Place oil on the shaft next to the bearing.
- C. Oil the connecting rod bearings every 3 months. Place oil on the shaft next to the bearing at the upper end and at the crank end of the connecting rod.

Lubrication when shaker is used for intermittent duty:

- A. Oil crank bearing through hole in center of bearing bracket every 6 months.
- B. Oil the 8 bearings located at the top and bottom of each of the 4 rocker arms every 6 months. Place oil on the shaft next to the bearing.
- C. Oil the connecting rod bearings every 6 months. Place oil on the shaft next to the bearing at the upper end and at the crank end of the connecting rod.

REPLACEMENT PARTS LIST FOR E6010.00

| <u>PART NO.</u> | <u>DESCRIPTION</u> | <u>QTY.</u> |
|------------------------|--|--------------------|
| 4283.2 | 3L290R V-BELT GATES #1290 | 1 |
| 4487 | 8" PULLEY X 1/2" BORE, 7.66" PITCH | 1 |
| 5528 | 3.75" SUCTION CUP W/ 5/16-18 THREADED POST | 4 |
| 6063.1 | CABLE TIE MOUNT, HOLE DIA (.025 - .125") | 3 |
| 6063.2 | CABLE TIE MOUNT, 2 WAY INTERNAL | 3 |
| 6129 | MDL5 OR GDL5 FUSE, 5AMP SLO-B | 1 |
| 6131 | BUSS FUSE HOLDER | 1 |
| 6272 | AC POWER INLET | 1 |
| 6518 | SWITCH | 1 |
| 6649 | PLUG 15A/125V TYPE B (115V) | 1 |
| 6800 | EBERBACH NAME PLATE | 1 |
| 7051.1 | MOTOR 1/6 HP, 1725/1140 RPM | 1 |
| 7617 | 6-32 X 1/2" S/S ROUND HD MACHINE SCREW | 2 |
| 8279 | #10-32 X 3/8" SELF LOCKING BUTTON HEAD CAP SCREW | 8 |
| 8285 | #8-32 x 1/4 TRUSS HEAD PHILLIPS | 16 |
| 8323 | 1/4-20 X 3/16" SET SCREW | 1 |
| 8518 | 1/4-28 X 3/4 HHCS | 4 |
| 8521 | 1/4-28 X 1.25" HEX HD CAP SCREW | 4 |
| 9175 | NO4. X 1/4" PAN HEAD SLOTTED SHEET METAL SCREW | 2 |
| 9206 | #6-32 NYLON LOCK NUT | 2 |
| 9222 | RECTANGULAR STEEL SPEED NUT 1/8" | 2 |
| 9236 | 8-32 THIN NYLON INSERT LOCK NUT | 2 |
| 9271 | 1/4-28 ZINC PLATED GRADE 5 STEEL HEX NUT | 8 |
| 9437 | 1/4" TYPE A WIDE ZINC PLATED WASHER | 12 |
| 9531 | 1/4-20 LOCK WASHER | 4 |
| 9609 | BLACK FIBER WASHER, 5/8OD X 25/64ID X 1/32T | 18 |
| 9627.5 | THRUST WASHER .515 X .885 X .06 DELRIN | 2 |
| EP6000.027 | SPACER ROD | 4 |
| EP6000.037 | SWITCH ESCUTCHEON | 1 |
| EP6000.090 | COLLAR | 10 |
| EP6000.526A | ROCKER ARM ASSEMBLY | 4 |

| | | |
|-------------|------------------------------------|---|
| EP6010.002 | REAR PANEL | 1 |
| EP6010.036 | OK-12 PULLEY | 1 |
| EP6010.500A | FRONT PANEL ASSEMBLY | 1 |
| EP6010.504A | BASE ASSEMBLY | 1 |
| EP6010.651A | WIRING HARNESS | 1 |
| EP6015.508A | CRANK SUB ASSEMBLY | 1 |
| EP6015.512A | TOP PLATE ASSEMBLY | 1 |
| EP6015.516A | CRANK BEARING BRACKET SUB ASSEMBLY | 1 |
| EP6015.529A | CONNECTING ROD ASSEMBLY | 1 |

CARRIERS AND ACCESSORIES

| <u>CAT NO.</u> | <u>DESCRIPTION</u> |
|----------------|---|
| E6040.00 | Utility Box Carrier |
| E6042.00 | Crosswise Bar Clamp |
| E6044.00 | Lengthwise Bar Clamp |
| E6047.00 | Box Carrier with Plexiglass Cover |
| E6010.00 | Shaker Platform |
| E6090.00 | Flask Holder for 10-2500 ml / 2800-6000 ml Flasks |

Visit us at www.Eberbachlabtools.com for a complete list of shakers and accessories.

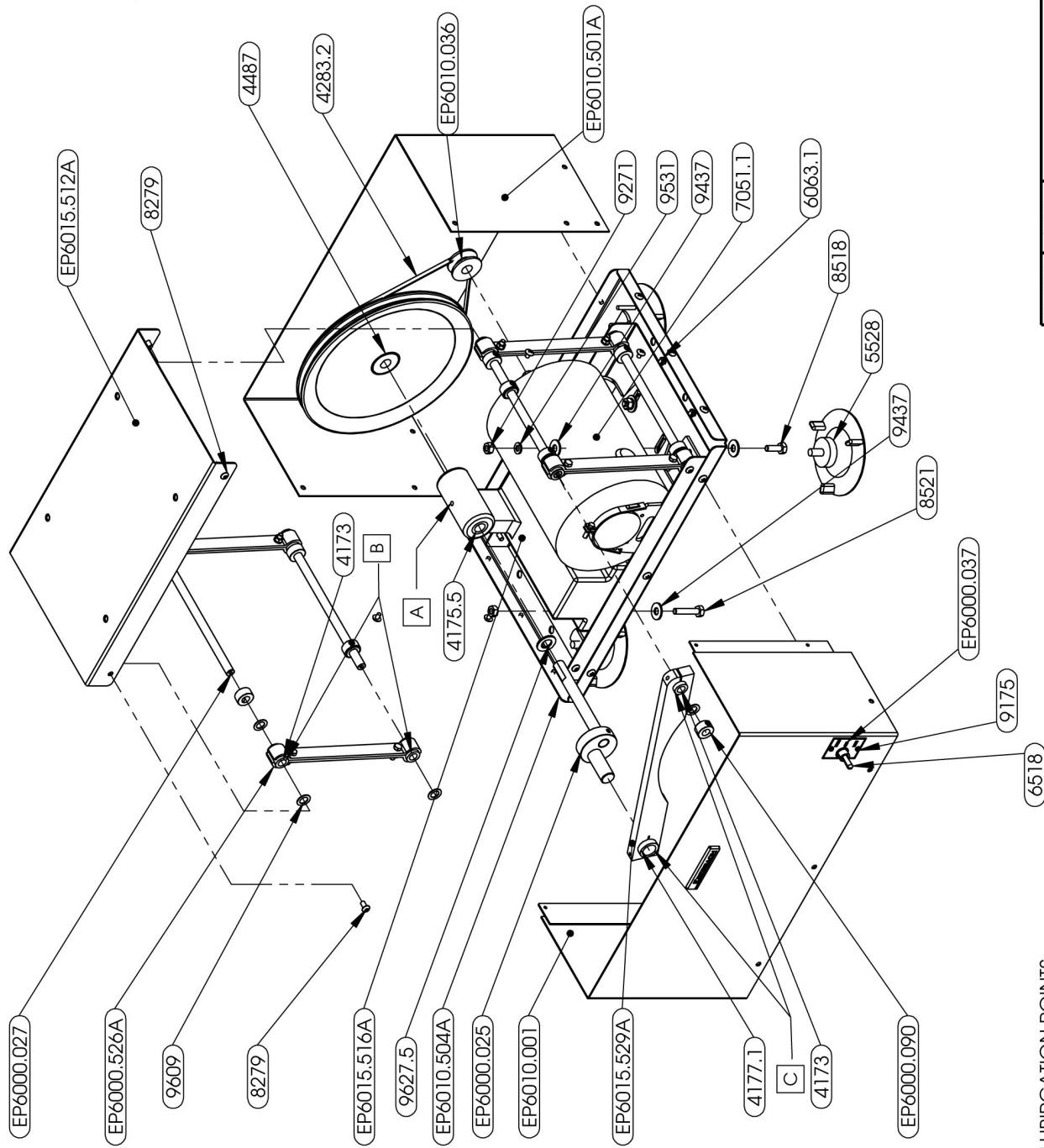

| PartNo | DESCRIPTION | QTY. |
|-------------|--|------|
| 4283.2 | 3/120UR V-BELT GATES # 1290 | 1 |
| 4487 | 8" PULLER X 1/2" BORE, 7.66" PITCH | 1 |
| 5528 | 3.75" SUCTION CUP W/ 5/16-18 THREADED POST | 4 |
| 6063.1 | CABLE TIE MOUNT, HOLE DIA .(025 - .125") | 3 |
| 6063.2 | CABLE TIE MOUNT, 2 WAY INTERNAL | 3 |
| 6129 | MDL5 OR GD1.5 FUSE, 5AMP SLO-B | 1 |
| 6131 | BUSS FUSE HOLDER | 1 |
| 6215 | NON INSULATED RING TERMINAL | 6 |
| 6217 | 1/4" QUICK DISCONNECT FEMALE F | 3 |
| 6217.5 | 0.187" QUICK DISCONNECT FEMALE F | 2 |
| 6226 | 1/4" FEMALE INSULATED QUICK CONNECTOR | 3 |
| 6272 | AC POWER INLET | 1 |
| 6518 | SWITCH | 1 |
| 6627.5 | 18 GA MACHINE TOOL WIRE RED | 6 |
| 6649 | PLUG 15A/125V TYPE B (115V) | 1 |
| 6800 | EBERBACH NAME PLATE | 1 |
| 7051.1 | MOTOR 1/6 HP, 1725/1140 RPM | 1 |
| 7617 | #6-32 X 1/2" S/S ROUND HD MACHINE SCREW | 2 |
| 8279 | # 10-32 X 3/8" NYLON LOCK BUTTON HD SOCKET SCREW | 8 |
| 8285 | #8-32 X 1/4" TRUST HEAD SCREW | 16 |
| 8323 | 1/4-20 X 3/16" SET SCREW | 1 |
| 8518 | 1/4"-28 X 3/4" ZINC PLTD HEX HD. CAP SCREW | 4 |
| 8621 | 1/4"-28 X 1.25" HEX HD. CAP SCREW | 4 |
| 9175 | NO.4 X 1/4" PAN HEAD SLOTTED SHEET METAL SCREW | 2 |
| 9206 | #6-32 NYLON LOCK NUT | 2 |
| 9222 | RECTANGULAR STEEL SPEED NUT 1/8" | 2 |
| 9235 | #8-32 18-8 S/S MACHINE SCREW NUT | 2 |
| 9271 | 1/4"-28 ZINC PLATED GRADE 5 STEEL HEX NUT | 8 |
| 9437 | 1/4" TYPE A WIDE ZINC PLATED WASHER | 12 |
| 9531 | 1/4" ZINC PLATED SPLIT LOCK WASHER | 4 |
| 9609 | BLACK FIBER WASHER. | 18 |
| 9627.5 | THRUST WASHER .515 X .885 X .06 DELRIN | 2 |
| EP6000.027 | SPACER ROD | 4 |
| EP6000.037 | SWITCH ESCUTCHEON | 1 |
| EP6000.090 | COLLAR | 10 |
| EP6000.526A | ROCKER ARM ASSEMBLY | 4 |
| EP6010.501A | BACK PANEL ASSEMBLY | 1 |
| EP6010.036 | OK-12 PULLEY | 1 |
| EP6010.500A | FRONT PANEL ASSEMBLY | 1 |
| EP6010.504A | BASE ASSEMBLY | 1 |
| EP6015.508A | CRANK SUB ASSEMBLY | 1 |
| EP6015.512A | TOP PLATE ASSEMBLY | 1 |
| EP6015.516A | CRANK BEARING BRACKET SUB ASSEMBLY | 1 |
| EP6015.529A | CONNECTING ROD ASSEMBLY | 1 |

LUBRICATION POINTS
USE SAE# 30 OIL

- ☐ A CRANK BEARING BLOCK
- ☐ B ROCKER ARM BEARINGS, 8 PLACES
- ☐ C CONNECTING ROD BEARING

[illegible]

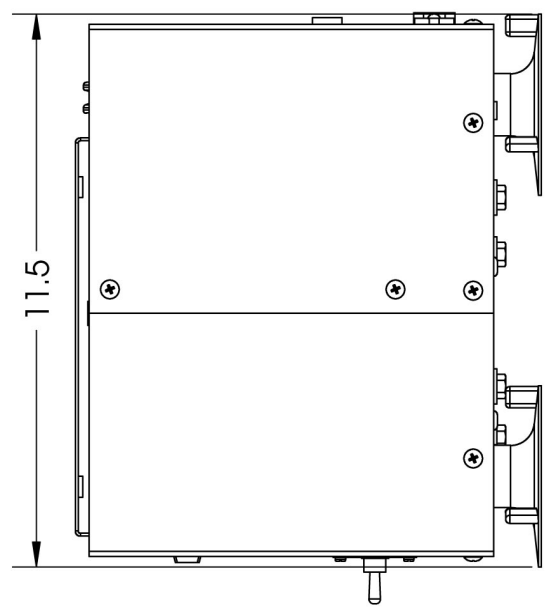
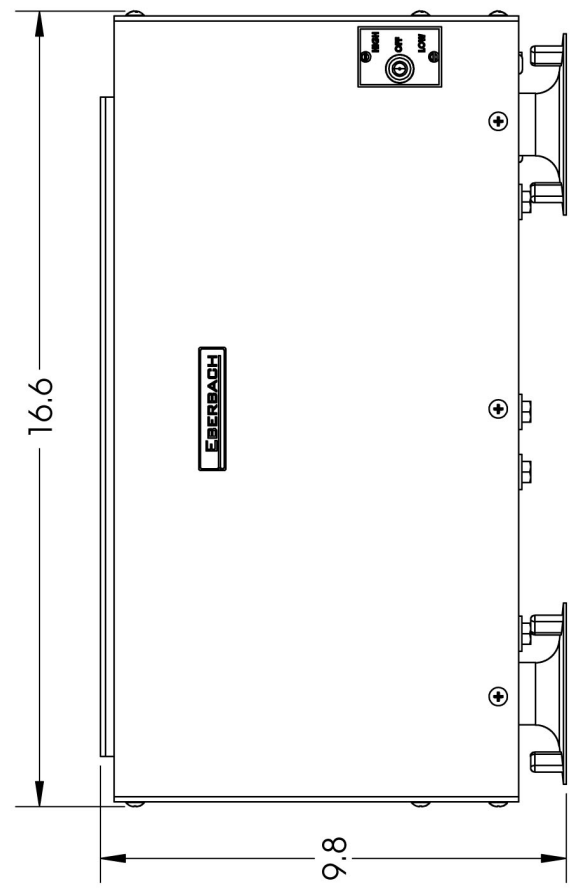
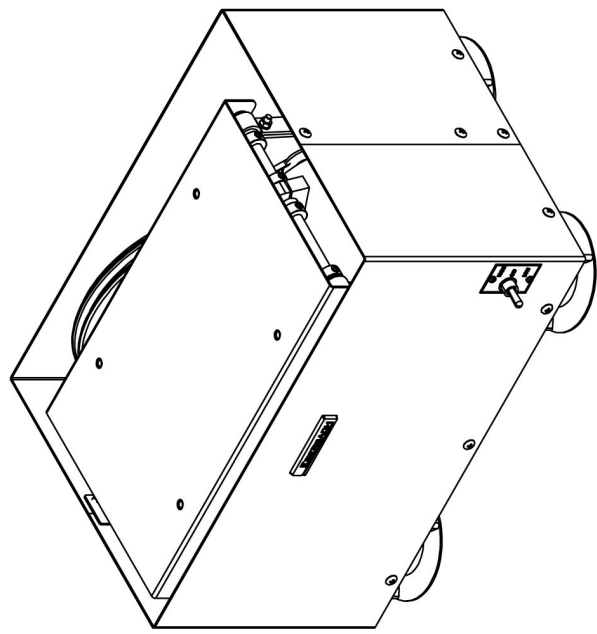
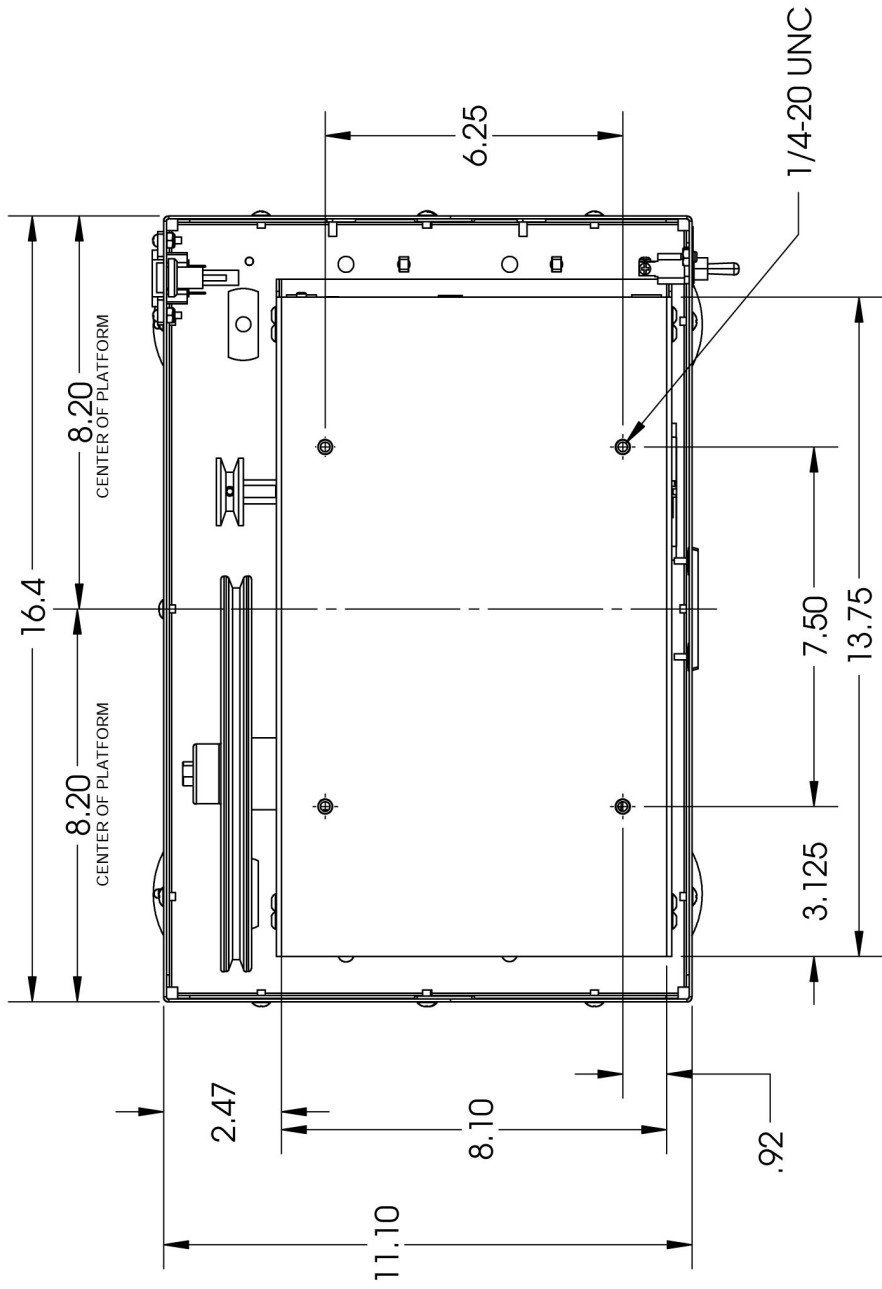

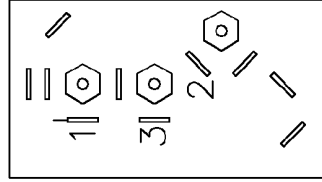

TWO SPEED 115V, 60HZ
180 OR 280 EXC. PER MINUTE

[illegible]